



HARLOW GARDENS, KINGSTON UPON THAMES, KT1
£2,995 per month*

Carter Jonas

HARLOW GARDENS, KINGSTON UPON

A modern very well presented three bedroom, two bathroom house with off street parking for one car. This property comprises of an entrance hall leading to a lovely reception room with open plan kitchen and dining area with integrated appliances and bi-fold doors opening out to the garden.

The first floor comprises two double bedrooms and family bathroom. The second floor has large double bedroom with ensuite. To the rear is a garden which is mainly laid to lawn with shrub borders and patio area. Off street parking to the front of the property.

Located within a mile from Kingston and Surbiton's popular High Streets, Harlow Gardens is ideally position for transport links into Central London from Berrylands National Rail Station (0.5 miles) and Surbiton National Rail Station (0.9 miles).

Council Tax - Band F

One week fee of intent - £691.15

Five week security deposit - £3455.76

- Council Tax Band = F
- 3 Bedrooms
- Off Street Parking
- Open Plan Reception
- En-Suite Bathroom
- Wooden floors downstairs
- Lawned Garden
- Available end February 2025
- EPC = B

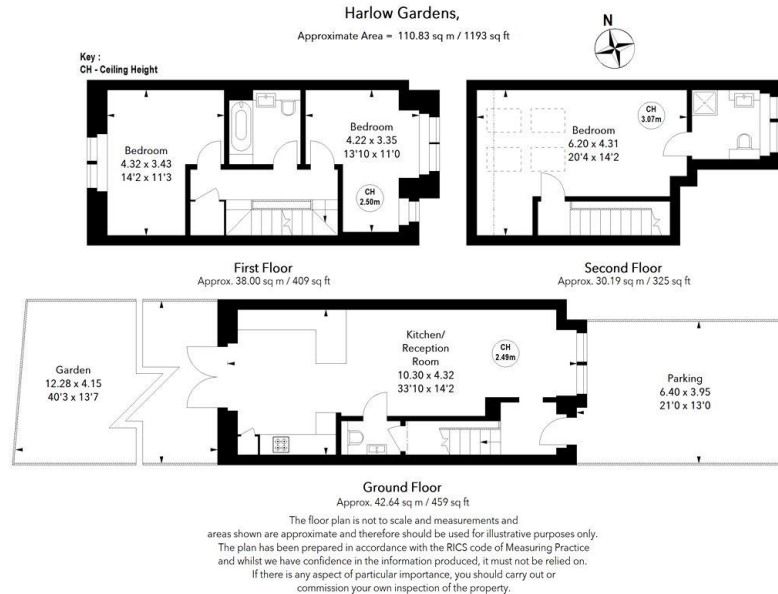

IMPORTANT INFORMATION

These particulars are for general information purposes only. The agent has made every attempt to ensure that the information is accurate and intended to amount to advice on which you should rely. The property can be found on the property listing on cartersjones.co.uk to confirm the details of any material information prior to planning, building regulations or other consents and CML. Distances given are approximate only. Where Carter Jones floorplan has been measured in accordance with IPMS, independent inspection or otherwise. Our images only represent the furnishings included; these are confirmed in a separate document which may apply depending on tenancy type. Please contact the agent for more information.

Barnes Lettings 020 8878 1115

barnes@carterjonas.co.uk

70 White Hart Lane, Barnes, SW13 0PZ



Exclusive UK affiliate of

CHRISTIE'S
INTERNATIONAL REAL ESTATE
Classification L2 - Business Data