



BATH STREET, BATH, BA1 1SB
£2,000 per month*

Carter Jonas

First Floor 2/3 bedroom central apartment with open plan kitchen/living room.

- Open plan Kitchen/Sitting Room
- 2 bedrooms
- 3rd bedroom/study
- Shower Room
- Central location

THE PROPERTY

This very central apartment, which has been the subject of a major renovation programme within the last couple of years, is accessed via a discreet entrance on the quiet Bilbury Lane/Bath Street via a wrought iron gate where elegant stone steps take you to the front door and smart communal entrance. With the location being just about as central as it gets, this apartment is perfect for city centre living. Flat 2 is on the second floor and has large, spacious rooms which comprise of open plan sitting room/kitchen, 2 double bedrooms, and shower room. There is a 3rd bedroom or study. The room proportions are particularly impressive, as are the height and size of the windows which all maximise the light and space in this wonderful Bath apartment. The apartment provides contemporary living right in the heart of Georgian Bath. The perfect city apartment, either for a professional couple, or two sharers. Offered unfurnished and available October 2024. REGRET NO STUDENTS.

Available for an initial 12 month tenancy.

EPC Rating D. Council Tax Band D (please see BANES website for current cost)

Mains electric, gas and metered mains water.

Can apply for a parking permit if required.

Internet & Mobile: Further information on availability and speeds can be found on the Ofcom website.

At a rent of £2,000 per calendar month: Holding deposit of 1 week's rent £461.53 Security deposit of 5 weeks rent £2,307.65



ADDITIONAL INFORMATION

Offers	Available for a minimum term of 12 months longer terms will be considered
--------	---

Viewing	Strictly by appointment
---------	-------------------------

Local Authority	- Council Tax Band D
-----------------	----------------------

Directions	
------------	--





Bath Street, Bath, BA1

Approximate Area = 1041 sq ft / 96.7 sq m

For identification only - Not to scale

Does not restrict
head height

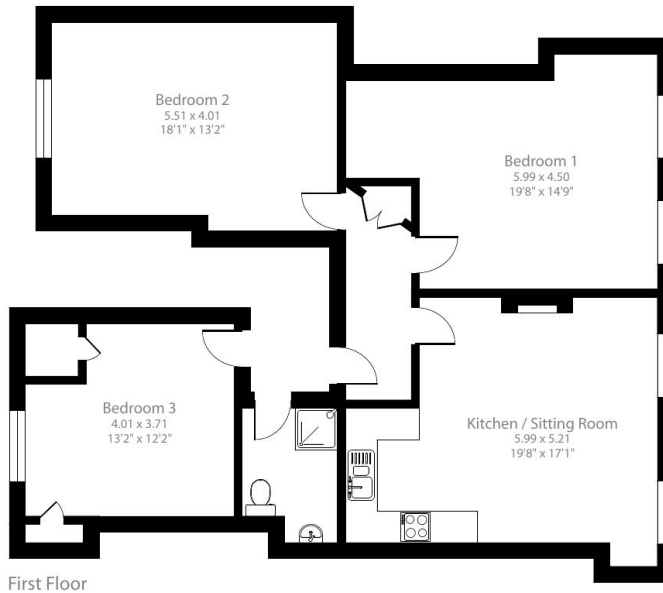

Certified
Property
Measurer

Floor plan produced in accordance with RICS Property Measurement Standards incorporating International Property Measurement Standards (IPMS2 Residential). © nlcocom 2024. Produced for Carter Jonas. REF: 1197897

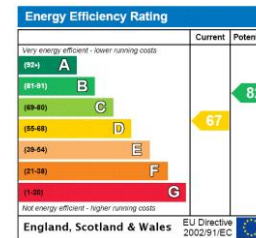

T: 01225 747250

5-6 Wood Street, Bath, Somerset, BA1 2JQ

E: bath@carterjonas.co.uk

A member of



Exclusive UK affiliate of

CHRISTIE'S
INTERNATIONAL REAL ESTATE

Classification L2 - Business Data

IMPORTANT INFORMATION

These particulars are for general information purposes only and do not represent an offer or contract or part of one. Carter Jonas or anyone in their employment has made every attempt to ensure that the particulars and other information provided are as accurate as possible and they are not intended to amount to advice on which you should rely as being factually accurate. Full information which may be relevant to your decision regarding the property can be found on the property listing on carterjonas.co.uk or a separately available material information sheet, and we would advise you to confirm the details of any material information prior to any offer being submitted. You should not assume that the property has all necessary planning, building regulations or other consents and Carter Jonas has not tested any services, facilities, or equipment. Any measurements and distances given are approximate only. Where Carter Jonas has been provided with a floorplan by a third party, we cannot guarantee that the floorplan has been measured in accordance with IPMS. Purchasers or prospective tenants must satisfy themselves of all of the aforementioned by independent inspection or otherwise. Our images only represent part of the property as it appeared at the time they were taken and do not represent the furnishings included; these are confirmed in a separate inventory. If you require further information, please contact us. *Administration fees may apply depending on tenancy type. Please contact your local branch for this information.