



**UPPER BERKELEY STREET, MARYLEBONE, W1H**

**£700 per week\***

**Carter Jonas**



## **FLAT 1, UPPER BERKELEY STREET, MARYLEBONE, LONDON, W1H 7PF**

- 2 Bedrooms
- 1 Reception Room
- 1 Bathroom
- Flat/Apartment
- First Floor (no lift)
- Unfurnished (Furnished at additional cost)

### **THE PROPERTY**

A first-floor apartment within a period building and comprising two double bedrooms, a naturally bright reception room, fitted kitchen and bathroom with shower.

Offered unfurnished (or furnished at additional cost)

Holding deposit = 1 weeks rent of £700 (at asking price)

Security deposit is 5 week's rent = £3,500 (at asking price £700pw)

Minimum Term 12 months

Council Tax Band E

For the latest information on broadband and mobile coverage, please visit [/checker.ofcom](https://www.ofcom.gov.uk/broadbandchecker/) for the most up-to-date details.

Upper Berkeley Street is a charming and picturesque street located in the heart of London. Situated in the affluent neighbourhood of Marylebone, the street is lined with elegant Georgian townhouses and offers easy access to numerous boutiques, restaurants, and cultural attractions, making it a popular destination for both locals and tourists alike. Marble Arch station is located approximately 0.2 miles and Edgware Road station approximately 0.6 miles.

A well-presented first floor two double bedroom apartment, offering bright, contemporary accommodation with period features situated in the heart of the West End and close to Oxford Street.



## ADDITIONAL INFORMATION

Offers Available for a minimum term of 12 months longer terms will be considered

Viewing Strictly by appointment

Local Authority Westminster City Council - Council Tax Band E



# Upper Berkeley Street, W1

Approximate Gross Internal Area  
58 sq m / 624 sq ft

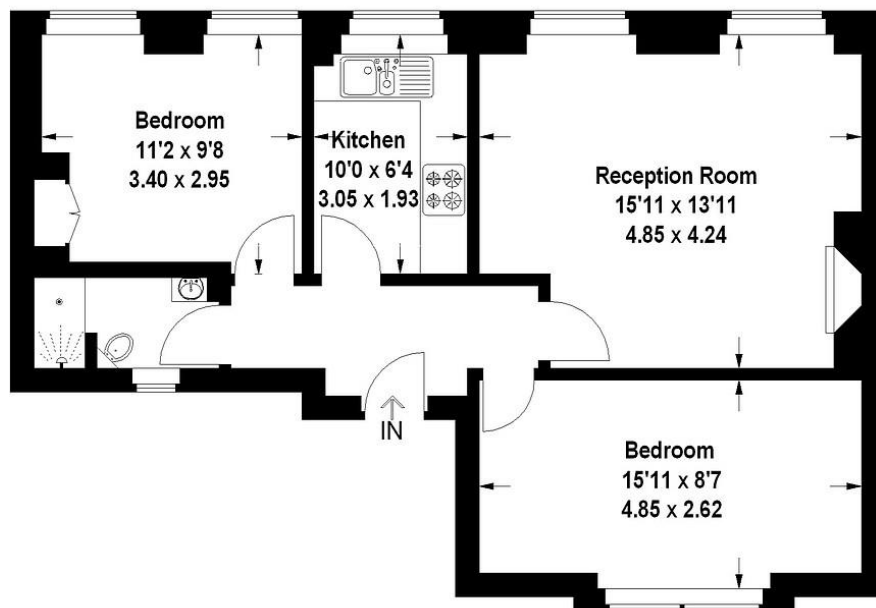

## First Floor

This plan is for layout guidance only. Not drawn to scale unless stated. Windows and door openings are approximate. Whilst every care is taken in the preparation of this plan, please check all dimensions, shapes and compass bearings before making any decisions reliant upon them. (ID 74928)

**T: 020 7486 8866**

37 New Cavendish Street, London, W1G 9TL

E: marylebone.lettings@carterjonas.co.uk

A member of



*Exclusive UK affiliate of*

**CHRISTIE'S**  
INTERNATIONAL REAL ESTATE

Classification L2 - Business Data



Energy Efficiency Rating		
Very energy efficient - lower running costs		
A		
B		
C		
D		
E		
F		
G		
Not energy efficient - higher running costs		
England, Scotland & Wales	EU Directive 2002/91/EC	

## IMPORTANT INFORMATION

These particulars are for general information purposes only and do not represent an offer or contract or part of one. Carter Jonas or anyone in their employment has made every attempt to ensure that the particulars and other information provided are as accurate as possible and they are not intended to amount to advice on which you should rely as being factually accurate. Full information which may be relevant to your decision regarding the property can be found on the property listing on [carterjonas.co.uk](http://carterjonas.co.uk) or a separately available material information sheet, and we would advise you to confirm the details of any material information prior to any offer being submitted. You should not assume that the property has all necessary planning, building regulations or other consents and Carter Jonas has not tested any services, facilities, or equipment. Any measurements and distances given are approximate only. Where Carter Jonas has been provided with a floorplan by a third party, we cannot guarantee that the floorplan has been measured in accordance with IPMS. Purchasers or prospective tenants must satisfy themselves of all of the aforementioned by independent inspection or otherwise. Our images only represent part of the property as it appeared at the time they were taken and do not represent the furnishings included; these are confirmed in a separate inventory. If you require further information, please contact us. \*Administration fees may apply depending on tenancy type. Please contact your local branch for this information.