



**MINNA FRANCES CLOSE, OXFORD, OX2**  
£2,500 per month\*

**Carter Jonas**



# MINNA FRANCES CLOSE, OXFORD, OX2

Brand new three bedroom property located on the Priory Grove Development.

Ground floor: Kitchen with fitted appliances and free standing Fridge Freezer. Living room with dual aspect windows and french doors to garden. W/C located off hallway. Benefits from underfloor heating.

First floor, primary bedroom with en suite. Double bedroom and spacious single bedroom, family bathroom with shower over bath. The first floor benefits from radiators.

Large rear garden with lawn and patio for alfresco dining. The garden boasts a bike store and also contains an air source heat

- Council Tax Band =
- Deposit Required = £2,884.62
- Long Let
- Brand New
- 3 Bedrooms
- Driveway Parking
- EV Charger
- Excellent Transport Links
- Solar Panels
- EPC = C

Energy Efficiency Rating		
	Current	Potential
Very energy efficient - lower running costs		
(92+) A		
(81-91) B		
(69-80) C	80	80
(55-68) D		
(39-54) E		
(21-38) F		
(1-20) G		
Not energy efficient - higher running costs		
England, Scotland & Wales	EU Directive 2002/91/EC	

Approximate Gross Internal Area 912 sq ft - 85 sq m

Ground Floor Area 453 sq ft – 42 sq m

First Floor Area 459 sq ft – 43 sq m

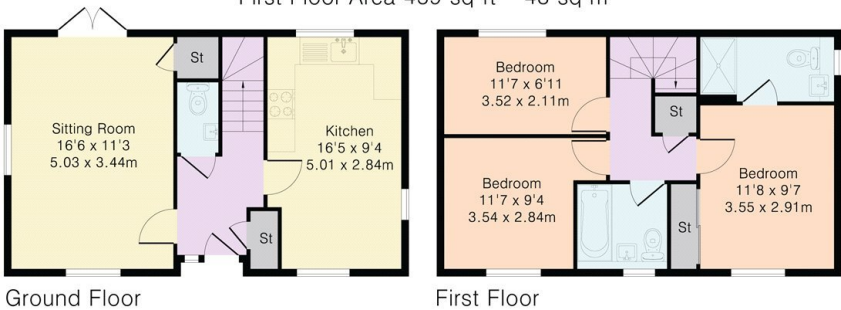

Oxford Lettings 01865 511444

oxfordresilettings@carterjonas.co.uk

Mayfield House, 256 Banbury Road, Oxford, Oxfordshire, OX2 7DE



Exclusive UK affiliate of

CHRISTIE'S  
INTERNATIONAL REAL ESTATE  
Classification L2 - Business Data

## IMPORTANT INFORMATION

These particulars are for general information purposes only and do not represent an offer or contract or part of one. Carter Jonas or anyone in their employment has made every attempt to ensure that the particulars and other information provided are as accurate as possible and they are not intended to amount to advice on which you should rely as being factually accurate. Full information which may be relevant to your decision regarding the property can be found on the property listing on [carterjonas.co.uk](http://carterjonas.co.uk) or a separately available material information sheet, and we would advise you to confirm the details of any material information prior to any offer being submitted. You should not assume that the property has all necessary planning, building regulations or other consents and Carter Jonas has not tested any services, facilities, or equipment. Any measurements and distances given are approximate only. Where Carter Jonas has been provided with a floorplan by a third party, we cannot guarantee that the floorplan has been measured in accordance with IPMS. Purchasers or prospective tenants must satisfy themselves of all of the aforementioned by independent inspection or otherwise. Our images only represent part of the property as it appeared at the time they were taken and do not represent the furnishings included; these are confirmed in a separate inventory. If you require further information, please contact us. \*Administration fees may apply depending on tenancy type. Please contact your local branch for this information.