



CHARLEVILLE COURT, CHARLEVILLE ROAD, W14
£1,950 per month*

Carter Jonas

FLAT 27, CHARLEVILLE COURT, CHARLEVILLE ROAD, LONDON, W14 9JG

- One bedroom
- One bathroom
- Sixth floor
- Lift
- West Kensington

LOCATION

Charleville Road is located in the grid of West Kensington and a short walk to both Barons Court and West Kensington underground stations it is also within easy access of all the shops, bars and restaurants the area has to offer.

THE PROPERTY

Bright and spacious one bedroom flat in the heart of West Kensington comprising of a spacious and bright living room, bedroom, separate kitchen and a bathroom.

Holding deposit = 1 weeks rent

Security deposit = 5 weeks rent

Council tax band: D

Minimum term: 12 months

A charming one bedroom flat located in West Kensington in a purpose built block on the sixth floor with a lift. EPC rating C



ADDITIONAL INFORMATION

Offers	Available for a minimum term of 12 months longer terms will be considered
--------	---

Viewing	Strictly by appointment
---------	-------------------------

Local Authority	Hammersmith and Fulham - Council Tax Band D
-----------------	---

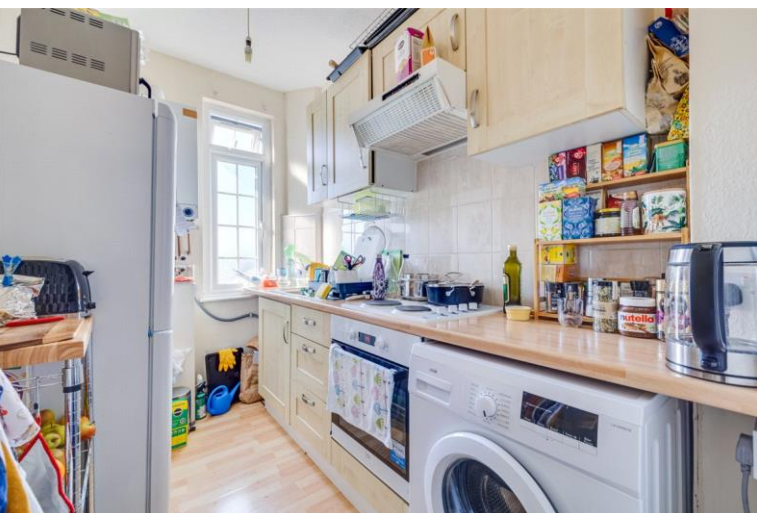

Charleville Court, W14

Approximate Area = 45.80 sq m / 493 sq ft

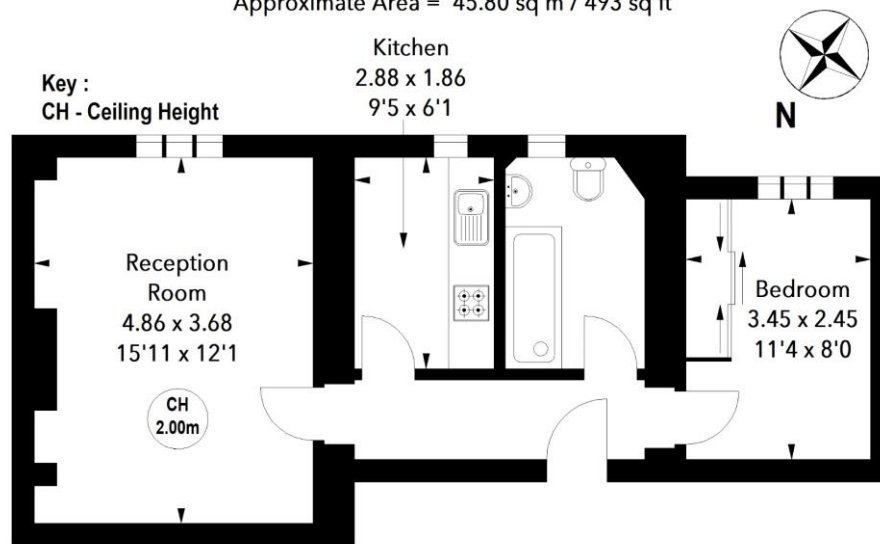

Sixth Floor

The floor plan is not to scale and measurements and areas shown are approximate and therefore should be used for illustrative purposes only.

The plan has been prepared in accordance with the RICS code of Measuring Practice and whilst we have confidence in the information produced, it must not be relied on.

If there is any aspect of particular importance, you should carry out or commission your own inspection of the property.

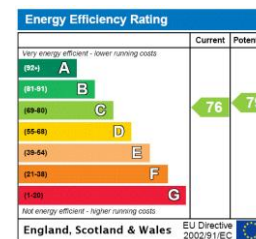

T: 020 7751 8898

361 Fulham Palace Road, London, SW6 6TA

E: parsonsgreen.residential.lettings@carterjonas.co.uk

A member of



Exclusive UK affiliate of

CHRISTIE'S
INTERNATIONAL REAL ESTATE

Classification L2 - Business Data

IMPORTANT INFORMATION

These particulars are for general information purposes only and do not represent an offer or contract or part of one. Carter Jonas or anyone in their employment has made every attempt to ensure that the particulars and other information provided are as accurate as possible and they are not intended to amount to advice on which you should rely as being factually accurate. Full information which may be relevant to your decision regarding the property can be found on the property listing on carterjonas.co.uk or a separately available material information sheet, and we would advise you to confirm the details of any material information prior to any offer being submitted. You should not assume that the property has all necessary planning, building regulations or other consents and Carter Jonas has not tested any services, facilities, or equipment. Any measurements and distances given are approximate only. Where Carter Jonas has been provided with a floorplan by a third party, we cannot guarantee that the floorplan has been measured in accordance with IPMS. Purchasers or prospective tenants must satisfy themselves of all of the aforementioned by independent inspection or otherwise. Our images only represent part of the property as it appeared at the time they were taken and do not represent the furnishings included; these are confirmed in a separate inventory. If you require further information, please contact us. *Administration fees may apply depending on tenancy type. Please contact your local branch for this information.