



BISHOPS MANSIONS, STEVENAGE ROAD, SW6
£1,150,000

Carter Jonas

BISHOPS MANSIONS, STEVENAGE ROAD, SW6

It features a stunning 23ft wide front reception/dining room with doors opening onto a beautiful south west facing balcony. There are 2 double bedrooms, a third bedroom/study, a WC, bathroom with separate shower and well equipped kitchen. Further benefits include a storage shed and access to the delightful communal gardens.

Bishops Mansions is a popular mansion block overlooking Fulham Tennis club and located close to the river walk and Bishops Park. Convenient access to a wide range of bus routes on Fulham Palace Road, with the nearest tube station at Putney Bridge underground (District Line 0.6 miles).

AMENITIES

- 3 Bedrooms
- 1 Bathroom
- 1 Reception Room
- Residents Parking
- Communal Garden
- South facing balcony

TENURE Share of Freehold

LOCAL AUTHORITY Hammersmith and Fulham

EPC BAND C

A FABULOUS RARELY AVAILABLE FIRST FLOOR FLAT IN THIS SOUGHT AFTER PERIOD BUILDING. ITS LOCATION IS ARGUABLY THE MOST DESIRABLE IN BISHOPS MANSIONS OFFERING PICTURESQUE VIEWS OVERLOOKING BISHOPS PARK.





Bishops mansions, SW6

Approximate Area = 98.57 sq m / 1061 sq ft

Key :
CH - Ceiling Height

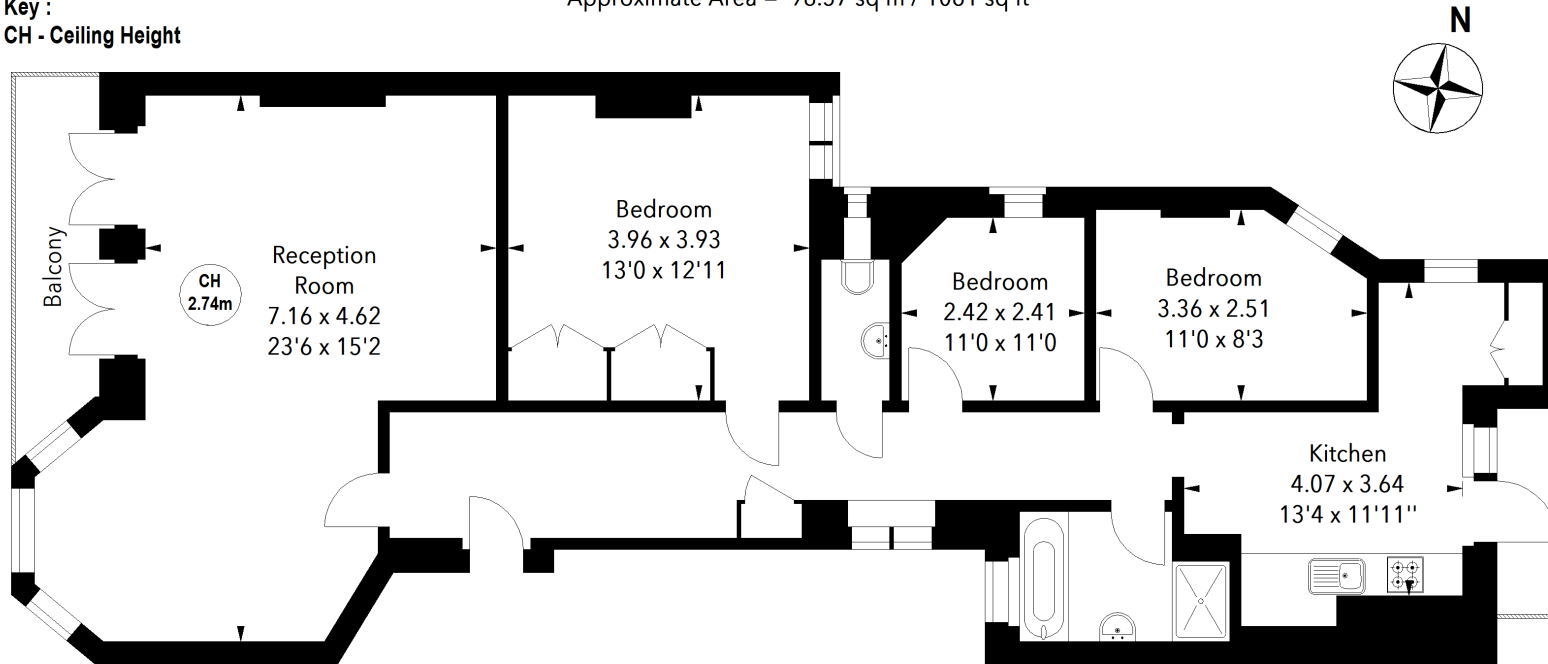

First Floor

The floor plan is not to scale and measurements and areas shown are approximate and therefore should be used for illustrative purposes only. The plan has been prepared in accordance with the RICS code of Measuring Practice and whilst we have confidence in the information produced, it must not be relied on. If there is any aspect of particular importance, you should carry out or commission your own inspection of the property.

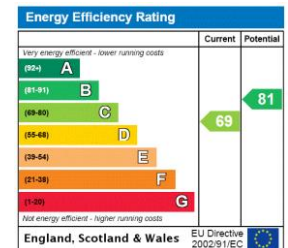

Fulham 020 7731 3333

bishopspark@carterjonas.co.uk
361 Fulham Palace Road, London, SW6 6TA

carterjonas.co.uk
Offices throughout the UK

Exclusive UK affiliate of
CHRISTIE'S
INTERNATIONAL REAL ESTATE

IMPORTANT INFORMATION

These particulars are for general information purposes only and do not represent an offer or contract or part of one. Carter Jonas or anyone in their employment has made every attempt to ensure that the particulars and other information provided are as accurate as possible and they are not intended to amount to advice on which you should rely as being factually accurate. Full information which may be relevant to your decision regarding the property can be found on the property listing on carterjonas.co.uk or, (including off market properties) on the brochure or a separately available material information sheet. We would advise you to confirm the details of any material information prior to any offer being submitted. You should not assume that the property has all necessary planning, building regulations or other consents and Carter Jonas has not tested any services, facilities or equipment. Any measurements and distances given are approximate only. Where Carter Jonas has been provided with a floorplan by a third party, we cannot guarantee that the floorplan has been measured in accordance with IPMS. Purchasers must satisfy themselves of all of the aforementioned by independent inspection or otherwise. Our images only represent part of the property as it appeared at the time they were taken and do not represent the furnishings included; these are confirmed in a separate inventory. If you require further information, please contact us.